

SETTING RINGS

- For zero setting of inside micrometers, three points internal micrometers and bore gages
- Deviation is the difference between the ordered size and the size marked on the setting ring when supplied. For example, the ordered size is .2", the size marked on the setting ring when supplied may be .20008"

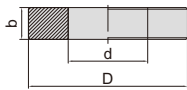

1.588-3.937" DIA

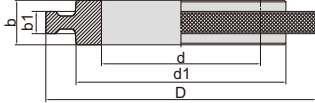

3.937-12" DIA



ACCURACY: CLASS XX
OF ASME B89.1.6

CAN SUPPLY CUSTOM SETTING RINGS
FROM 1/16" TO 12", FOR EXAMPLE, .6726"



6313-0D8

Product name		Setting Ring	Marked Size		0.69953	
Code No.	6313-0D8		Diameter	at 0°	at 90°	
Serial No.	2005-149296		Top	0.69991	0.69994	
Standard temperature	68 °F		Middle	0.69991	0.69994	
Traceable to	10339D-K-15015-01-02/2012-09		Bottom	0.69993	0.69994	
Judgement	Passed		Average	0.69993		
Inspector	S. Yang		Cylindricity	0.00002		
			Roundness	0.00053		

6

Diameter d**	b	D	Deviation	Roundness and cylindricity
.059-.098"	.157"	.866"	±.00006"	.000012"
.098-.118"	.197"	.866"	±.00008"	.000016"
.118-.197"	.197"	.866"	±.00008"	.000016"
.197-.394"	.315"	1.260"	±.00008"	.000016"
.394-.591"	.394"	1.496"	±.00010"	.000020"
.591-.709"	.472"	1.772"	±.00010"	.000020"
.709-.787"	.472"	1.772"	±.00012"	.000024"
.787-.984"	.551"	2.087"	±.00012"	.000024"
.984-1.181"	.630"	2.480"	±.00014"	.000028"
1.181-1.260"	.630"	2.480"	±.00014"	.000028"
1.260-1.575"	.709"	2.795"	±.00014"	.000028"
1.575-1.969"	.787"	3.346"	±.00014"	.000028"
1.969-2.362"	.787"	3.937"	±.00016"	.000032"
2.362-2.756"	.945"	4.409"	±.00016"	.000032"
2.756-3.150"	.945"	4.921"	±.00016"	.000032"
3.150-3.543"	.945"	5.512"	±.00016"	.000040"
3.543-3.937"	.945"	6.300"	±.00016"	.000040"

* For example .709-.787" means .709" DIA < diameters ≤ .787" DIA

Diameter d**	b	b1	d1	D	Deviation	Roundness and cylindricity
3.937-4.331"	1.102"	.551"	5.197"	6.693"	±.00020"	.000040"
4.331-4.724"	1.102"	.630"	5.512"	7.087"	±.00020"	.000040"
4.724-5.118"	1.102"	.630"	5.906"	7.480"	±.00024"	.000047"
5.118-5.512"	1.102"	.709"	6.299"	7.874"	±.00024"	.000047"
5.512-5.906"	1.102"	.709"	6.693"	8.346"	±.00024"	.000047"
5.906-6.299"	1.102"	.787"	7.087"	8.819"	±.00024"	.000047"
6.299-6.693"	1.260"	.787"	7.480"	9.291"	±.00024"	.000047"
6.693-7.087"	1.260"	.787"	7.874"	9.843"	±.00024"	.000047"
7.087-7.480"	1.260"	.866"	8.346"	10.433"	±.00028"	.000055"
7.480-7.874"	1.260"	.866"	8.819"	11.024"	±.00028"	.000055"
7.874-8.346"	1.260"	.866"	9.291"	11.811"	±.00028"	.000055"
8.346-8.819"	1.260"	.984"	9.843"	12.402"	±.00028"	.000055"
8.819-9.291"	1.417"	.984"	10.433"	13.189"	±.00028"	.000055"
9.291-9.843"	1.417"	1.102"	11.024"	13.976"	±.00028"	.000055"
9.843-10.433"	1.417"	1.102"	11.811"	14.764"	±.00032"	.000063"
10.433-11.024"	1.417"	1.102"	12.402"	15.748"	±.00032"	.000063"
11.024-11.811"	1.417"	1.260"	13.189"	16.732"	±.00032"	.000063"
11.811-12.402"	1.417"	1.260"	13.976"	17.717"	±.00032"	.000063"

Part No.	Diameter	Part No.	Diameter	Part No.	Diameter	Part No.	Diameter	Part No.	Diameter
6313-1H16*	1/16" DIA	6313-1H2*	1/2" DIA	6313-15H16*	15/16" DIA	6313-1D4*	1.4" DIA	6313-5D5*	5.5" DIA
6313-3H32*	3/32" DIA	6313-17H32*	17/32" DIA	6313-31H32*	31/32" DIA	6313-1D6*	1.6" DIA	6313-6*	6.0" DIA
6313-1H8*	1/8" DIA	6313-9H16*	9/16" DIA	6313-0D1*	.1" DIA	6313-1D8*	1.8" DIA	6313-6D5*	6.5" DIA
6313-5H32*	5/32" DIA	6313-19H32*	19/32" DIA	6313-0D16*	.16" DIA	6313-2*	2.0" DIA	6313-7*	7.0" DIA
6313-3H16*	3/16" DIA	6313-5H8*	5/8" DIA	6313-0D24*	.24" DIA	6313-2D4*	2.4" DIA	6313-7D5*	7.5" DIA
6313-7H32*	7/32" DIA	6313-21H32*	21/32" DIA	6313-0D275*	.275" DIA	6313-2D5*	2.5" DIA	6313-8*	8.0" DIA
6313-1H4*	1/4" DIA	6313-11H16*	11/16" DIA	6313-0D35*	.35" DIA	6313-2D8*	2.8" DIA	6313-8D5*	8.5" DIA
6313-9H32*	9/32" DIA	6313-23H32*	23/32" DIA	6313-0D425*	.425" DIA	6313-3*	3.0" DIA	6313-9*	9.0" DIA
6313-5H16*	5/16" DIA	6313-3H4*	3/4" DIA	6313-0D6*	.6" DIA	6313-3D2*	3.2" DIA	6313-9D5*	9.5" DIA
6313-11H32*	11/32" DIA	6313-25H32*	25/32" DIA	6313-0D65*	.65" DIA	6313-3D5*	3.5" DIA	6313-10*	10.0" DIA
6313-3H8*	3/8" DIA	6313-13H16*	13/16" DIA	6313-0D7*	.7" DIA	6313-3D6*	3.6" DIA	6313-10D5*	10.5" DIA
6313-13H32*	13/32" DIA	6313-27H32*	27/32" DIA	6313-0D8*	.8" DIA	6313-4*	4.0" DIA	6313-11*	11.0" DIA
6313-7H16*	7/16" DIA	6313-7H8*	7/8" DIA	6313-1*	1.0" DIA	6313-4D5*	4.5" DIA	6313-11D5*	11.5" DIA
6313-15H32*	15/32" DIA	6313-29H32*	29/32" DIA	6313-1D2*	1.2" DIA	6313-5*	5.0" DIA	6313-12*	12.0" DIA

* Supplied with manufacturer inspection certificate

SMALL HOLE GAGE SET

- 4 gages per set
- For small holes, slots and grooves, etc.
- Satin chrome finish



4208-1

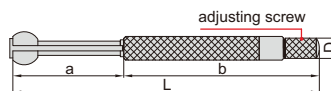

Part No.	Total range	Gages included
4208-1	.125~.5"	.125~.2", .2~.3", .3~.4", .4~.5"

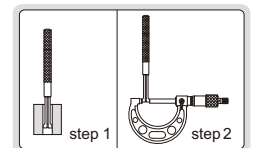

Range	L	a	b	D
.125~.2"	2.992"	.945"	2.047"	.197" DIA
.2~.3"	3.110"	1.063"	2.047"	.197" DIA
.3~.4"	3.465"	1.181"	2.283"	.236" DIA
.4~.5"	3.583"	1.339"	2.283"	.236" DIA